

## Almi AL1 Manual Pipe Notching Machine

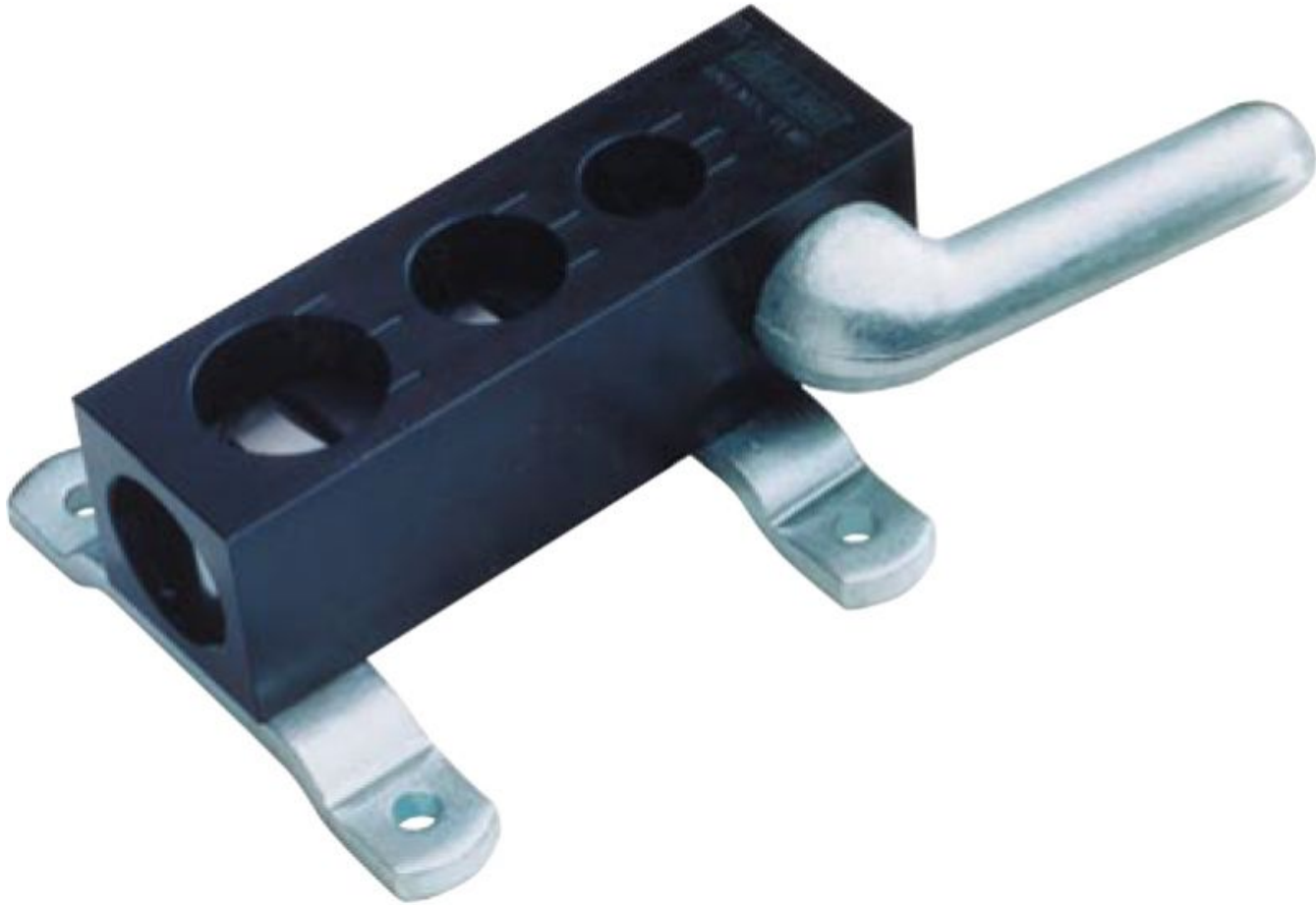

**Stock Code:** 17008

The Almi range of pipe notching machines are manufactured in Holland and provide the perfect solution to notching tubes prior to welding. The AL1, AL2 and AL3 manual notchers are an excellent cost effective solution for 90° joins. The AL1-2E motorised model is ideal for intensive use whilst the AL1-2U incorporates a venting slot notch. Large range, fast notching, perfect fit.

## Features

## Technical Specification

MODEL	AL1
Capacity mm	27.9 / 34.8 / 42.8
Angle notch to 60°	NO
Vent notch	NO
Motor kW	-
Length mm	195
Width mm	60
Height mm	60
Weight kg	8